



Design: **SCANDINAVIAN HOME**  
Floors: **2**  
Gross area: **1890 sq ft**  
Net area: **1450 sq ft**  
Bedrooms: **3**

Bathrooms:	<b>1</b>
Windows area:	<b>654 sq ft</b>
Roof area:	<b>1830 sq ft</b>
Ridge height:	<b>23 ft</b>
Carport:	<b>Yes</b>

Open to below space is one of the key features of this layout. The constantly changing nature outside the window will become a part of the interior. Tall windows allow to observe all the shades of the weather and high roof with overhangs creates a feeling of a reliable refuge.

## First floor

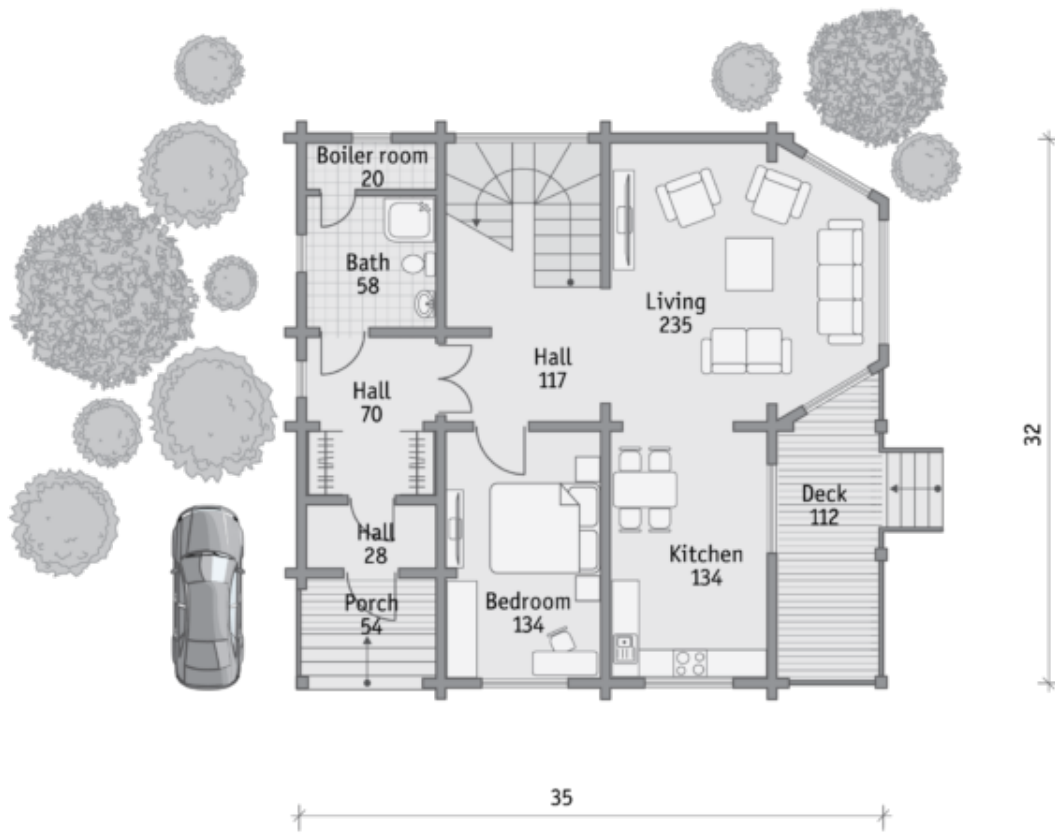

## Second floor

