

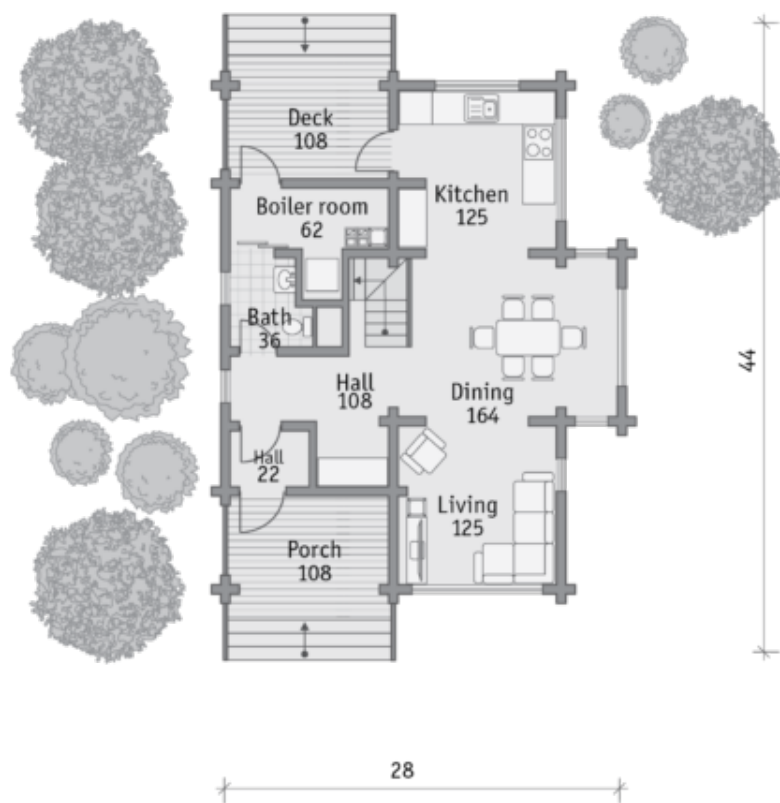

Floors:	2
Gross area:	1680 sq ft
Net area:	1370 sq ft
Bedrooms:	3
Bathrooms:	3
Windows area:	329 sq ft
Roof area:	1959 sq ft
Ridge height:	23 ft
Carport:	Yes

The area of the ground floor with the dining room, living room and kitchen is enlarged by the use of the porch and terrace. Three bedrooms on the second floor are located around the staircase which allows to avoid long halls in the floorplan layout.

First floor



Second floor

