



Design:	<b>30 BEST OFFERS</b>
Floors:	<b>1</b>
Gross area:	<b>2500 sq ft</b>
Net area:	<b>1500 sq ft</b>
Bedrooms:	<b>4</b>
Bathrooms:	<b>2</b>
Roof area:	<b>3300 sq ft</b>
Ridge height:	<b>21 ft</b>
Carport:	<b>Yes</b>

Classic, spacious and symmetric house placed among hundred-year-old coniferous trees. The house features two separate living areas, which makes it a good fit for an Airbnb rental facility. As with all of our floor plans, modifications to interior layout are possible.

# First floor

Floor plan M1:100

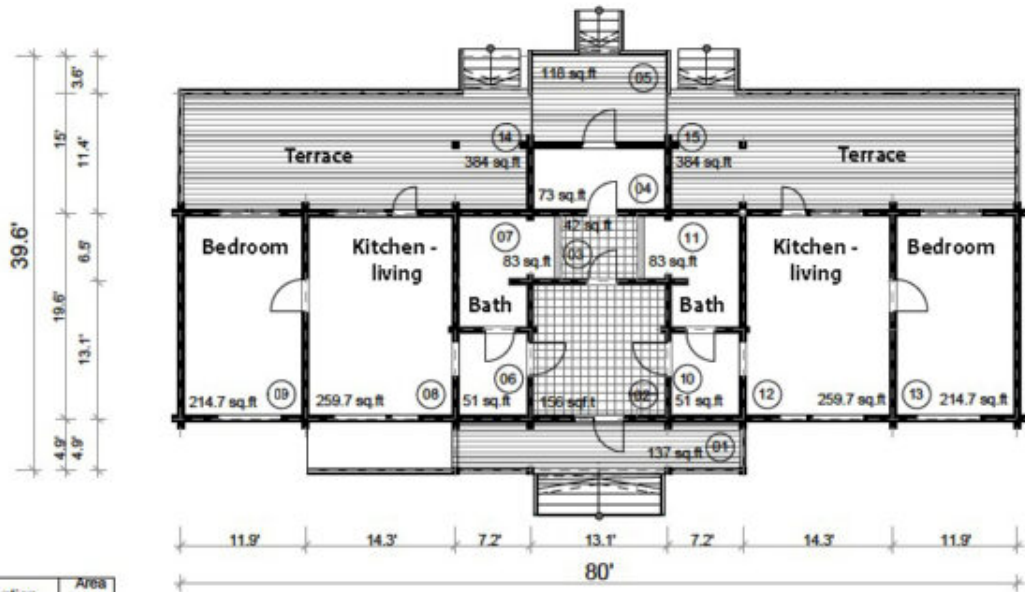

#	Explication	Area sq.ft
01	Porch	137
02	Entry	156
03	Mechanical room	42.8
04	Storage	73.6
05	Porch 2	118
06	Entry 1	51
07	Bathroom 1	83.2
08	Kitchen - living	259.7
09	Bedroom 1	214.7
10	Entry 2	51
11	Bathroom 2	83.2
12	Kitchen - living 2	259.7
13	Bedroom 2	214.7
14	Terrace 1	384
15	Terrace 2	384

Net area = 1,491 sq.ft  
Porch and terrace area = 1,024 sq.ft  
Total area = 2,515 sq.ft  
Construction area = 2,917 sq.ft



























